

# 4 Fi

Fumistería inoxidable  
Stainless steel connecting flue pipe  
Fumisterie inoxydable

## Ø80 - 400

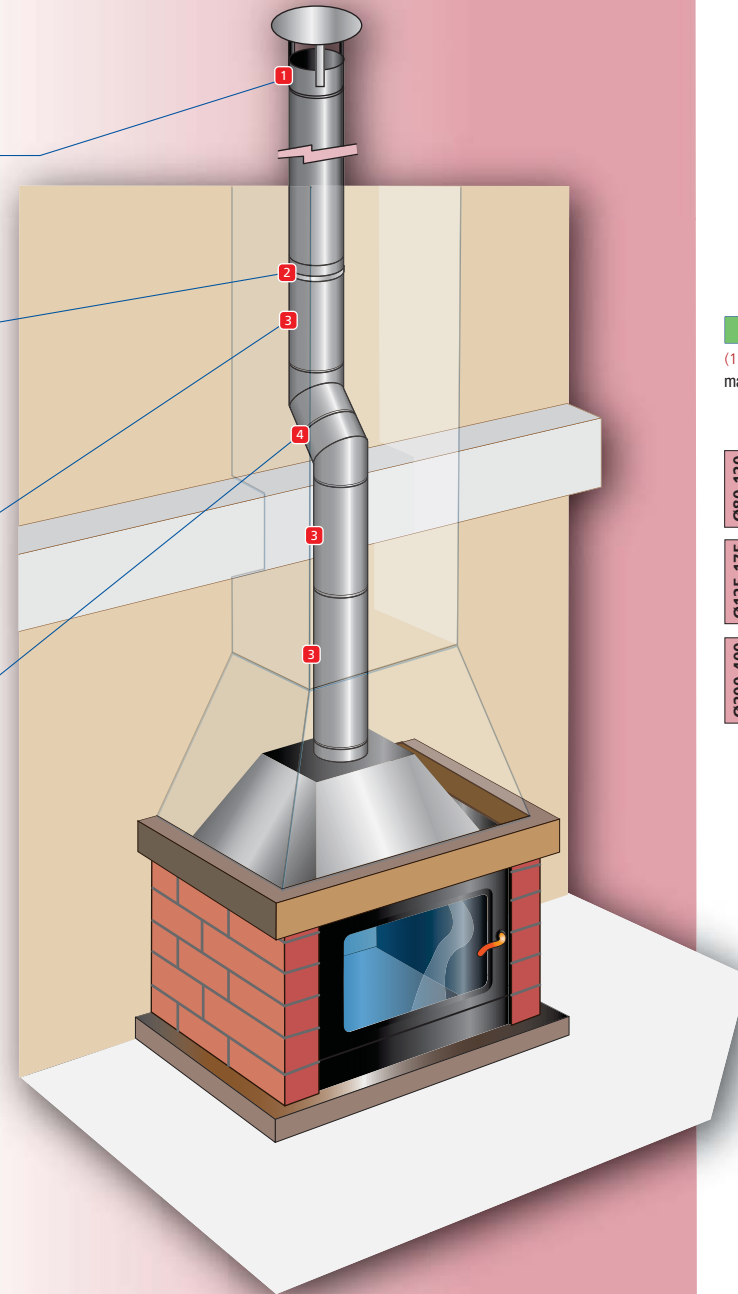
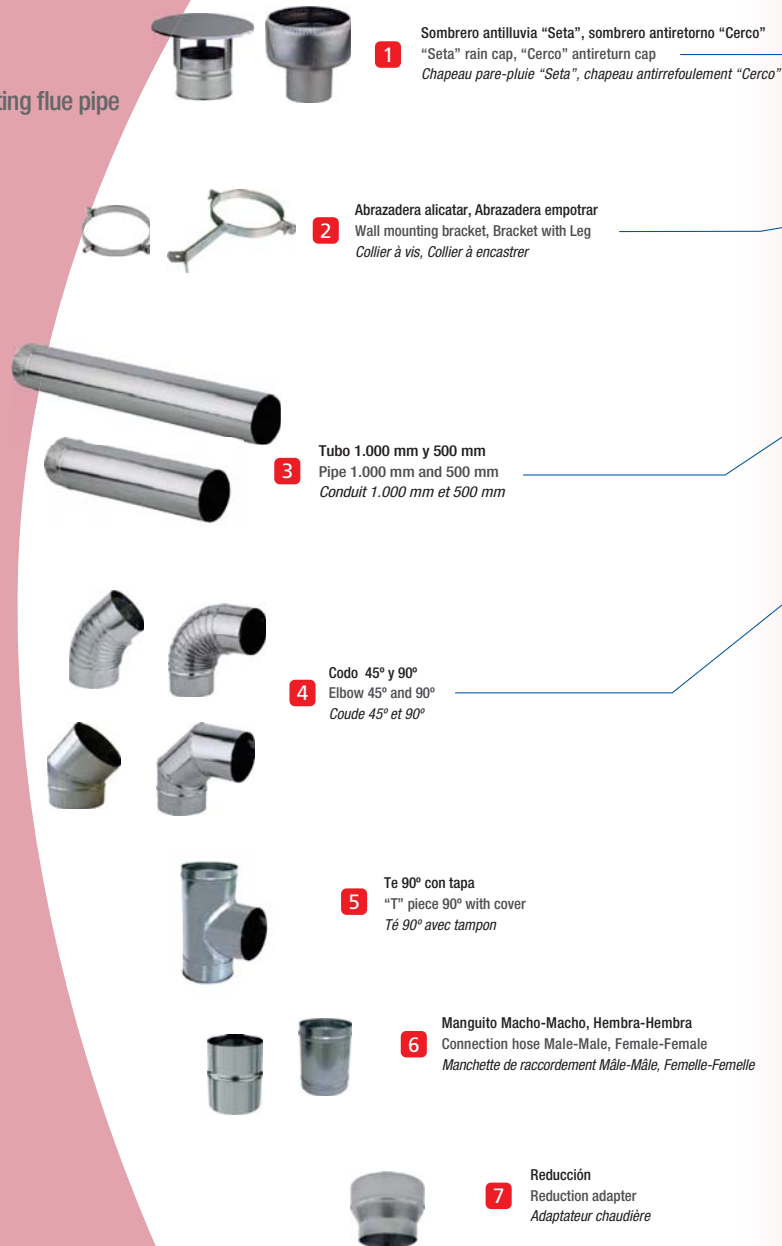

CE Especificaciones de acuerdo a la legislación europea en productos de construcción CPR  
Specifications according to EU product regulations of construction CPR  
Spécifications Selon la réglementation européenne concernant les produits de construction CPR

AISI 304L  
(1.4307) 2B  
mate | matt | mat



EN 1856-2

|          |  |
|----------|--|
| Ø80-120  | T600 N1 D Vm L20040 G(600) NM                                  |
| Ø125-175 | T600 N1 D Vm L20050 G(600) NM<br>T600 N1 D Vm L20060 G(600) NM |
| Ø200-400 | T600 N1 D Vm L20080 G(600) NM                                  |



|  |               |         |  |
|--|---------------|---------|--|
| Referencia<br>Reference<br>Référence             | <b>Ref.</b>   | 5301150 | Unidad de embalaje<br>Packaging unit<br>Unités par emballage |
| Precio unidad €<br>Unit price, €<br>Prix unité € | <b>€   U.</b> | 17      |  |

| Diámetro   diameter   diamètre Ø  |   | 80   | 100     | 120     | 125     | 130     | 150     | 175     |         |
|---|---|------|---------|---------|---------|---------|---------|---------|---------|
| Espesor   Sheet thickness   Épaisseur paroi   |   | 0,4  |         |         | 0,5     |         |         |         |         |
| Tubo<br>Pipe<br>Conduit<br><b>1.000 mm</b>  |    | Ref. | 5301080 | 5301100 | 5301120 | 5301125 | 5301130 | 5301150 | 5301175 |
|   | €   U.  | 10   | 10      | 10      | 10      | 10      | 17      | 15      |         |
| Tubo<br>Pipe<br>Conduit<br><b>500 mm</b>  |    | Ref. | 5302080 | 5302100 | 5302120 | 5302125 | 5302130 | 5302150 | 5302175 |
|   | €   U.  | 10   | 10      | 10      | 10      | 10      | 15      | 15      |         |
| Codo rizado<br>Ridged Elbow<br>Coude plissé<br><b>45°</b>   |    | Ref. | 5311080 | 5311100 | 5311120 | 5311125 | 5311130 | 5311150 | 5311175 |
|   | €   U.  | 8    | 8       | 8       | 8       | 8       | 8       | 8       | 8       |
| Codo rizado<br>Ridged Elbow<br>Coude plissé<br><b>90°</b>   |    | Ref. | 5313080 | 5313100 | 5313120 | 5313125 | 5313130 | 5313150 | 5313175 |
|   | €   U.  | 4    | 4       | 4       | 4       | 4       | 4       | 4       | 4       |
| Te 90° con tapa<br>"T" piece 90° with Cover<br>Té 90° avec tampon   |    | Ref. |         |         | 5321120 | 5321125 | 5321130 | 5321150 | 5321175 |
|   | €   U.  |      |         | 1       | 1       | 1       | 1       | 1       | 1       |
| Sombrero antilluvia "Seta"<br>"Seta" Rain Cap<br>Chapeau pare-pluie "Seta"  |    | Ref. | 5332080 | 5332100 | 5332120 | 5332125 | 5332130 | 5332150 | 5332175 |
|   | €   U.  | 1    | 1       | 1       | 1       | 1       | 1       | 1       | 1       |
| Sombrero antiretorno "Cercos"<br>"Cercos" Antireturn Cap<br>Chapeau anti-refoulement "Cercos"                         |    | Ref. | 5433080 | 5433100 | 5433120 | 5433125 | 5433130 | 5433150 | 5433175 |
|   | €   U.  | 1    | 1       | 1       | 1       | 1       | 1       | 1       | 1       |
| Abrazadera alicatar<br>Wall mounting bracket<br>Collier à vis   |    | Ref. | 5471080 | 5471100 | 5471120 | 5471125 | 5471130 | 5471150 | 5471175 |
|   | €   U.  | 1    | 1       | 1       | 1       | 1       | 1       | 1       | 1       |
| Abrazadera empotrar<br>Bracket with Leg<br>Collier à encastrer  |   | Ref. | 5472080 | 5472100 | 5472120 | 5472125 | 5472130 | 5472150 | 5472175 |
|   | €   U.  | 1    | 1       | 1       | 1       | 1       | 1       | 1       | 1       |
| Manguito Macho-Macho<br>Connection hose Male-Male<br>Manchette de raccordement Mâle-Mâle<br><b>200 mm</b>             |  | Ref. | 5351080 | 5351100 | 5351120 | 5351125 | 5351130 | 5351150 | 5351175 |
|   | €   U.  | 1    | 1       | 1       | 1       | 1       | 1       | 1       | 1       |
| Manguito Hembra-Hembra<br>Connection hose Female-Female<br>Manchette de raccordement Femelle-Femelle<br><b>200 mm</b> |  | Ref. | 5352080 | 5352100 | 5352120 | 5352125 | 5352130 | 5352150 | 5352175 |
|   | €   U.  | 1    | 1       | 1       | 1       | 1       | 1       | 1       | 1       |
| Reducción   Reduction Adapter   Réduction<br>Ø 125  |  | Ref. |         |         | 5441120 |         |         |         |         |
|   | €   U.  |      |         | 1       |         |         |         |         |         |
| Reducción   Reduction Adapter   Réduction<br>Ø 130  |  | Ref. |         |         | 5442120 | 5442125 |         |         |         |
|   | €   U.  |      |         | 1       | 1       |         |         |         |         |
| Reducción   Reduction Adapter   Réduction<br>Ø 150  |  | Ref. |         |         | 5443120 | 5443125 | 5443130 |         |         |
|   | €   U.  |      |         | 1       | 1       | 1       |         |         |         |
| Reducción   Reduction Adapter   Réduction<br>Ø 175  |  | Ref. |         |         |         |         |         | 5444150 |         |
|   | €   U.  |      |         |         |         |         |         | 1       |         |
| Reducción   Reduction Adapter   Réduction<br>Ø 200  |  | Ref. |         |         |         |         |         | 5445150 | 5445175 |
|   | €   U.  |      |         |         |         |         |         | 1       | 1       |

| Diámetro   diameter   diamètre Ø  |   | 200  | 225     | 250     | 300     | 350     | 400     |         |
|---|---|------|---------|---------|---------|---------|---------|---------|
| Espesor   Sheet thickness   Épaisseur paroi   |   | 0,8  |         |         |         |         |         |         |
| Tubo<br>Pipe<br>Conduit<br><b>1.000 mm</b>  |    | Ref. | 5401200 | 5401225 | 5401250 | 5401300 | 5401350 | 5401400 |
|   | €   U.  | 4    | 4       | 3       | 3       | 1       | 1       |         |
| Tubo<br>Pipe<br>Conduit<br><b>500 mm</b>  |    | Ref. | 5402200 | 5402225 | 5402250 | 5402300 | 5402350 | 5402400 |
|   | €   U.  | 4    | 4       | 3       | 3       | 1       | 1       |         |
| Codo<br>Elbow<br>Coude<br><b>45°</b>  |    | Ref. | 5415200 | 5415225 | 5415250 | 5415300 | 5415350 | 5415400 |
|   | €   U.  | 8    | 8       | 8       | 8       | 8       | 8       | 8       |
| Codo<br>Elbow<br>Coude<br><b>90°</b>  |    | Ref. | 5416200 | 5416225 | 5416250 | 5416300 | 5416350 | 5416400 |
|   | €   U.  | 4    | 4       | 4       | 4       | 4       | 4       | 4       |
| Te 90° con tapa<br>"T" piece 90° with Cover<br>Té 90° avec tampon   |    | Ref. | 5421200 |         | 5421250 | 5421300 |         |         |
|   | €   U.  | 1    |         | 1       | 1       |         |         |         |
| Sombrero antilluvia "Seta"<br>"Seta" Rain Cap<br>Chapeau pare-pluie "Seta"  |    | Ref. | 5432200 | 5432225 | 5432250 | 5432300 | 5432350 | 5432400 |
|   | €   U.  | 1    | 1       | 1       | 1       | 1       | 1       | 1       |
| Sombrero antiretorno "Cercos"<br>"Cercos" Antireturn Cap<br>Chapeau anti-refoulement "Cercos"                         |    | Ref. | 5433200 | 5433225 | 5433250 | 5433300 | 5433350 | 5433400 |
|   | €   U.  | 1    | 1       | 1       | 1       | 1       | 1       | 1       |
| Abrazadera alicatar<br>Wall mounting Bracket<br>Collier à vis   |    | Ref. | 5471200 | 5471225 | 5471250 | 5471300 | 5471350 | 5471400 |
|   | €   U.  | 1    | 1       | 1       | 1       | 1       | 1       | 1       |
| Abrazadera empotrar<br>Bracket with Leg<br>Collier à encastrer  |   | Ref. | 5472200 | 5472225 | 5472250 | 5472300 | 5472350 | 5472400 |
|   | €   U.  | 1    | 1       | 1       | 1       | 1       | 1       | 1       |
| Manguito Macho-Macho<br>Connection hose Male-Male<br>Manchette de raccordement Mâle-Mâle<br><b>200 mm</b>             |  | Ref. | 5451200 |         |         |         |         |         |
|   | €   U.  | 1    |         |         |         |         |         |         |
| Manguito Hembra-Hembra<br>Connection hose Female-Female<br>Manchette de raccordement Femelle-Femelle<br><b>200 mm</b> |  | Ref. | 5452200 |         |         |         |         |         |
|   | €   U.  | 1    |         |         |         |         |         |         |
| Reducción   Reduction Adapter   Réduction<br>Ø 225  |  | Ref. | 5441200 |         |         |         |         |         |
|   | €   U.  | 1    |         |         |         |         |         |         |
| Reducción   Reduction Adapter   Réduction<br>Ø 250  |  | Ref. | 5442200 |         |         |         |         |         |
|   | €   U.  | 1    |         |         |         |         |         |         |
| Reducción   Reduction Adapter   Réduction<br>Ø 300  |  | Ref. |         |         | 5443250 |         |         |         |
|   | €   U.  |      |         | 1       |         |         |         |         |
| Reducción   Reduction Adapter   Réduction<br>Ø 350  |  | Ref. |         |         |         | 5444300 |         |         |
|   | €   U.  |      |         |         |         | 1       |         |         |
| Reducción   Reduction Adapter   Réduction<br>Ø 400  |  | Ref. |         |         |         |         | 5445350 |         |
|   | €   U.  |      |         |         |         |         | 1       |         |